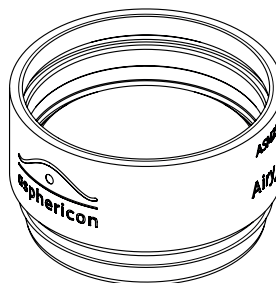
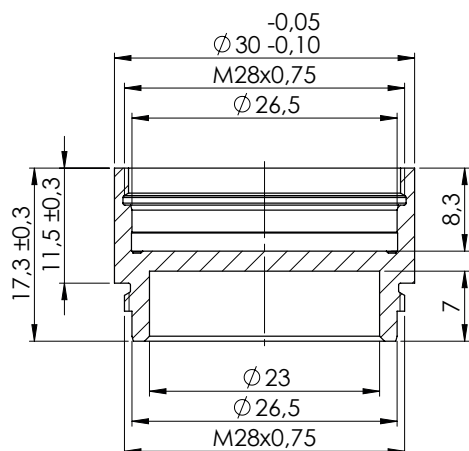

**SQM25-10-D-C-1064**

Want to create squared Top-Hat profiles in the focus? No problem with the a|SqAiryShape. This beam shaper generates in combination with a focusing lens different squared focused beam profiles (e.g. Top-Hat, Donut) from collimated Gaussian beams. It impresses with a compact design (only 17.3 mm in length) and can be easily incorporated into existing application set-ups.

**Key Benefits:**

- = Design wavelength: 1064 nm, usable wavelength range: 1000 - 1600 nm
- = Also available design wavelengths [355 nm / 532 nm / 632 nm / 780 nm]
- = Generation of different beam profiles (e.g. Top-Hat, Donut, Beam Waist)
- = Profile size easily scalable by focal length
- = Easy integration into existing set-ups
- = Perfect alignment by high-precision mounting
- = Compact design
- = Input beam diameter @  $1/e^2 = 10$  mm; output beam diameter  $d_{\text{Airy}} = 10$  mm
- = Laser induced damage threshold: 12 J/cm<sup>2</sup>, 100 Hz, 6 ns, 532 nm  
*For higher laser power applications please request a V-Coating.  
Contact us for an individual offer.*

**Technical Dimensions:**

asphericon GmbH  
Stockholmer Str. 9 | 07747 Jena  
Germany



+49 (0) 3641 - 3100 560  
+49 (0) 3641 - 3100 561

asphericon s.r.o.  
Miliřská 449 | Jeřmanice 463 12  
Czech Republic



+420 488 100 300

asphericon, Inc.  
2601 Cattlemen Road, Suite 301  
Sarasota, FL 34232 | USA



+1 - 941 - 564 0890



[sales@asphericon.com](mailto:sales@asphericon.com)



[www.asphericon.com](http://www.asphericon.com)