

a|Adapter

Connect BeamTuning elements conveniently to any optical set-up with matching adapters. Intra-system a|Adapters allow to use a|BeamExpander in both functional directions, to expand or reduce the beam diameter. The cross-system a|Adapters guarantee a high level of compatibility with other optical systems (e.g. Qioptiq, OWIS) – without additional adjustment.

Technical Dimensions:

C-MOUNT MALE

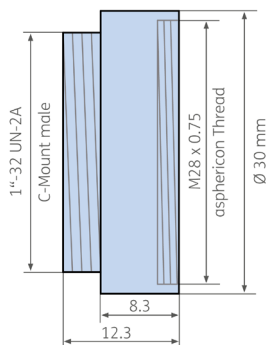

C-MOUNT FEMALE

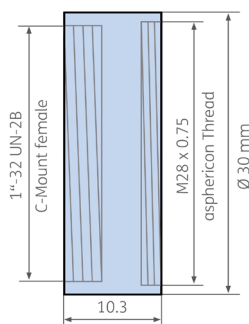

1.2" CIRCUMFERENCE (DUAL USE)

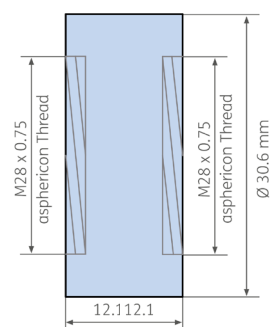

SM1 MALE

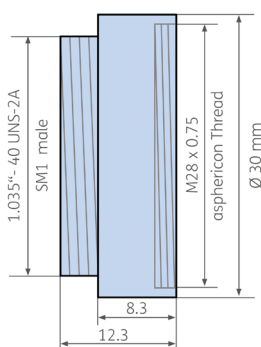

SM1 FEMALE

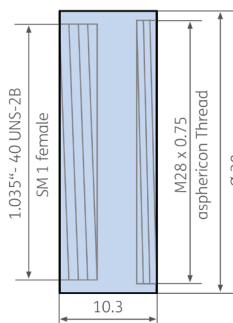

INTRA-SYSTEM

